

SMA Straight Panel Receptacle Plug (Coaxial End)

SMA1GFA50-2450A/111

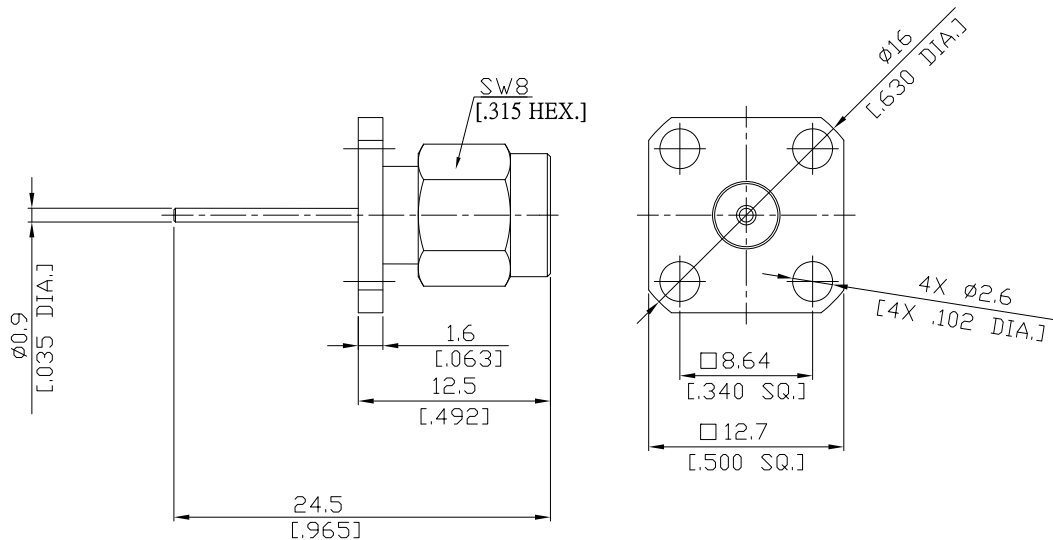

All dimensions are in mm [inch]

Tolerances according to DIN ISO 2768-mH

Interface

According to MIL-C-39012; MIL-STD-348A/310

Electrical Data

Impedance: 50 Ω
Frequency: DC to 18 GHz
VSWR (Return Loss): ≤ 1.25 (≥ 19.08 dB)
Insertion Loss: $\leq 0.05 \times \sqrt{F}$ (GHz) dB

Mechanical Data

Coupling mechanisms: Screw-lock
Weight: 0.0042 kg

Environmental Data

Temperature range: -65°C to +165°C
RoHS: compliant

Material And Plating

Piece Parts	Material	Plating
Centre contact	Brass	Gold plating(Nickel underplated)
Body	Brass	Gold plating(Nickel underplated)
Insulator	PTFE	
Gasket	Silicone Rubber	
Coupling nut	Brass	Gold plating(Nickel underplated)

Packing

Single or 100

Related Document

Mounting Dimension MD71